

NOTES:

1. BUSHING IS IMPREGNATED WITH CARTER STANDARD NEVERLUBE LUBRICANT
2. ALL EXPOSED SURFACES HAVE BLACK OXIDE
3. CUSTOM LASER ETCHING AVAILABLE UPON REQUEST

DRAWING NO.

SFHE-80-B

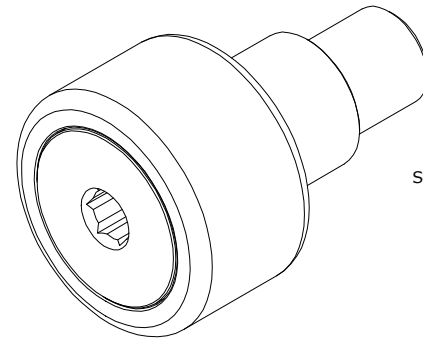

ISO VIEWS  
SCALE .5625 : 1

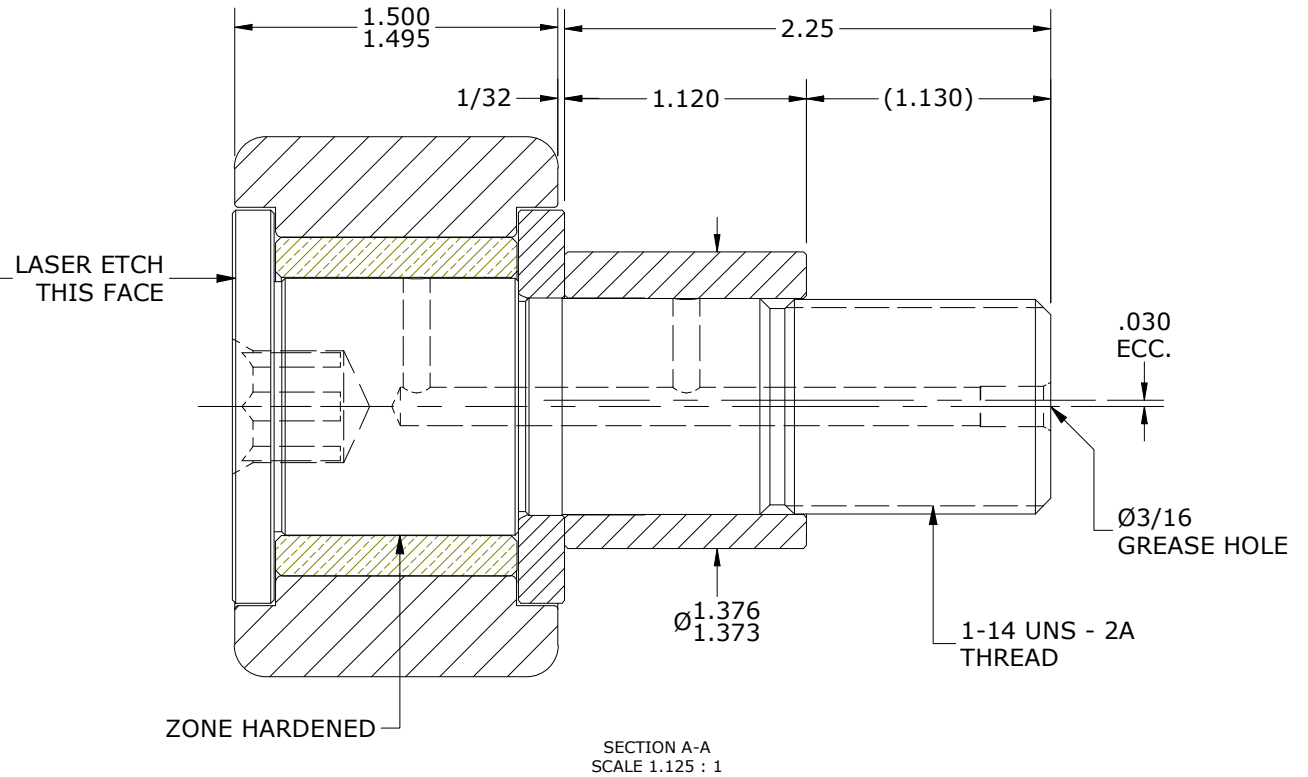
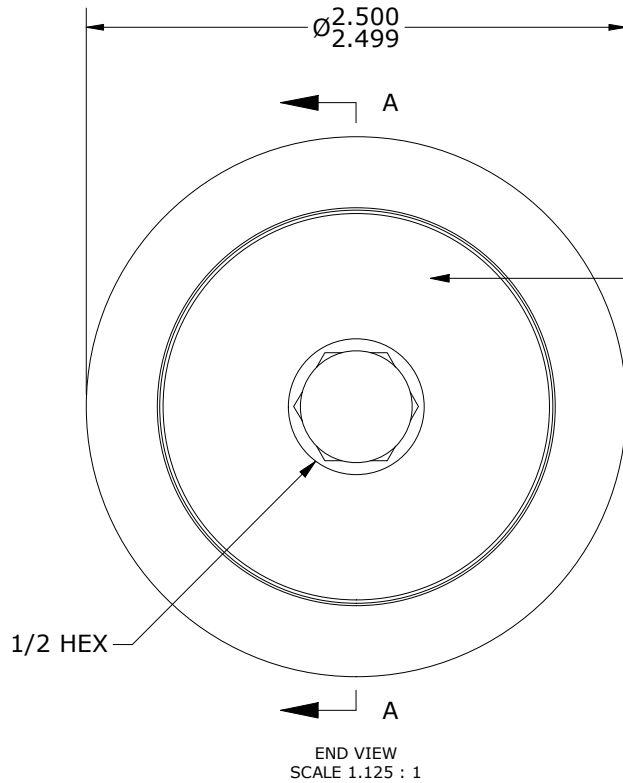
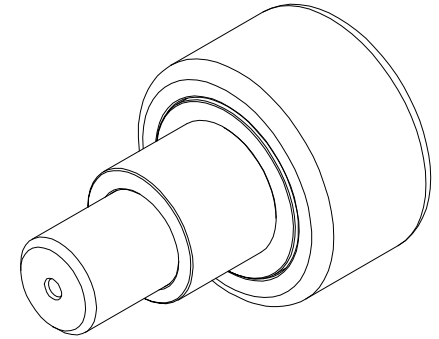

MATERIAL NOTES:

- OUTER RING - BEARING STEEL, HEAT TREATED
- STUD - BEARING STEEL, ZONE HARDENED
- BUSHING - SINTERED BRONZE
- WASHER - BEARING STEEL, HEAT TREATED
- ECCENTRIC SLEEVE - STEEL

CUSTOMER PART#

XX = ± .01  
XXX = ± .005  
XXXX = ± .0005  
ANGLES = ± 2'  
INCH [METRIC]  
FRACTION = ± 1/64

CARTER MANUFACTURING IS NOT RESPONSIBLE FOR TYPOGRAPHICAL ERRORS

**CARTER MANUFACTURING CO., INC.**

GRAND HAVEN, MICHIGAN 49417

ENGINEERING CHANGE ORDER NOTE

REVISION

PART NAME: ASSEMBLY

PRODUCT TYPE: SFH

B

AUTHOR BY

DRAWN BY

CHK'D BY

SALES

MATERIAL

HG

SGW

SGW

KR

NOTED

REVISION BY

DATE

DATE

DATE

DATE

SHEET

MD

4/13/2023

12/20/2016

4/13/2023

12/20/2016

1 OF 2