

MAXIMUM CLAMPING TORQUE**	
Inch lbf	Nm
1,725	195

1. BUSHING IS IMPREGNATED WITH CARTER STANDARD NEVERLUBE LUBRICANT.
2. ALL EXPOSED SURFACES HAVE BLACK OXIDE.
3. CUSTOM LASER ETCHING IS AVAILABLE UPON REQUEST.

SFH-104-B

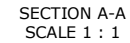
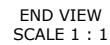
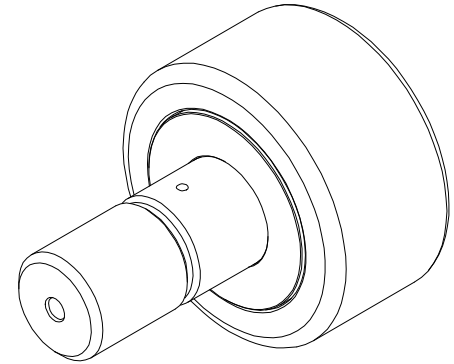

1 OF 2