

LOAD RATINGS

RATING	lbf	Newtons
RADIAL BASIC DYNAMIC	6,472	28,789
MAXIMUM STATIC CAPACITY	14,798	65,824

RECOMMENDED MOUNTING HOLE Ø

Limit	Inch	mm
MIN	1.1250	28.5750
MAX	1.1255	28.5877

NOTES:
 1. BEARING IS PACKED WITH NLGI GRADE 2, FOOD GRADE H1 GREASE (UNLESS OTHERWISE SPECIFIED)
 2. LIMITING SPEED:
 A. GREASE = 1,400

MAXIMUM CLAMPING TORQUE

Thread Type	Inch Lbs	Nm
DRY	1,500	169.5
LUBRICATED	750	84.7

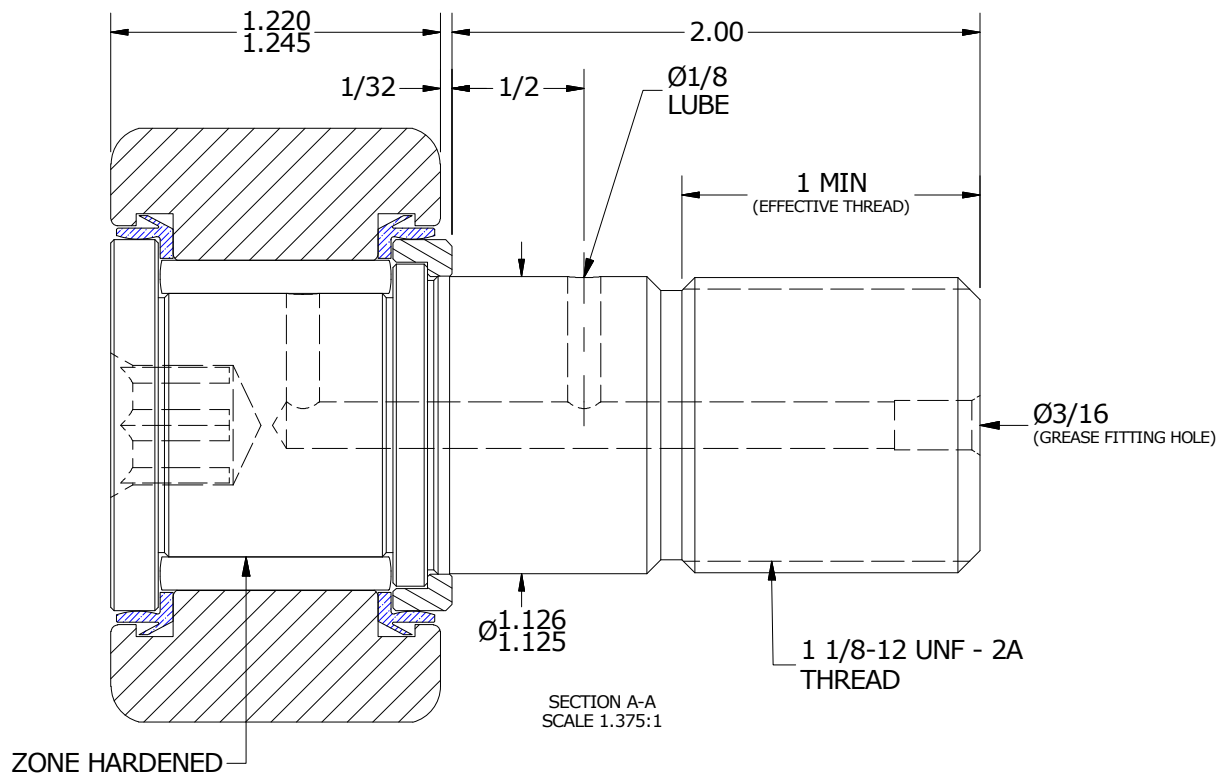
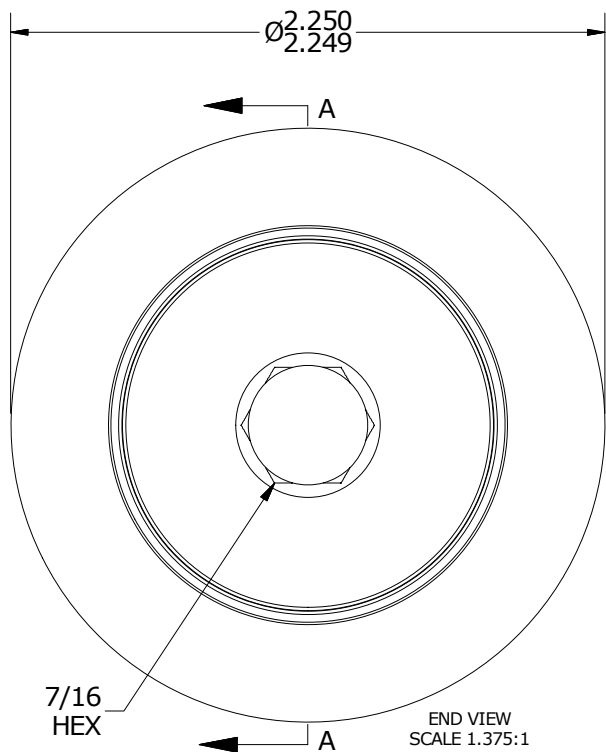
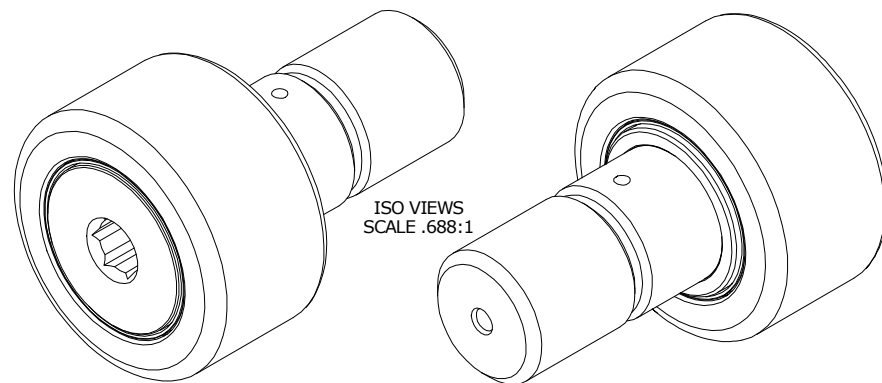

MATERIAL NOTES:

OUTER - 440C STAINLESS STEEL, HEAT TREATED
 STUD - 440C STAINLESS STEEL, ZONE HARDENED
 ROLLER - 440C STAINLESS STEEL, HEAT TREATED
 WASHER - 440C STAINLESS STEEL, HEAT TREATED
 SEAL - SYNTHETIC

CUSTOMER PART# _____
 XX = ± .01
 XXX = ± .005
 XXXX = ± .0005
 ANGLES = ± 1'
 INCH [METRIC]
 FRACTION = ± 1/32

CARTER MANUFACTURING IS NOT RESPONSIBLE FOR TYPOGRAPHICAL ERRORS

CARTER MANUFACTURING CO., INC.
 GRAND HAVEN, MICHIGAN 49417

ENGINEERING CHANGE ORDER NOTE

REVISION		PART NAME: Assembly			PRODUCT TYPE: CNB / SC	
B	AUTHOR BY HG	DRAWN BY JAF	CHK'D BY MD	SALES KR	MATERIAL NOTED	
REVISION BY JLB	DATE 8/9/2018	DATE 7/26/2006	DATE 8/9/2018	DATE 8/8/2018	SHEET 1 OF 2	