

LOAD RATINGS		
RATING	lbf	Newtons
RADIAL BASIC DYNAMIC	14,270	63,476
STATIC THRUST LOAD	12,000	53,379
MAXIMUM STATIC CAPACITY	20,000	88,964

- NOTES:
1. BEARING IS PACKED WITH NLGI GRADE 2, LITHIUM BASED GREASE UNLESS OTHERWISE SPECIFIED
  2. ALL EXPOSED SURFACES HAVE BLACK OXIDE
  3. CUSTOM LASER ETCHING AVAILABLE UPON REQUEST

MAXIMUM CLAMPING TORQUE**		
Thread Type	ft lbs	Nm
LUBRICATED	50	68

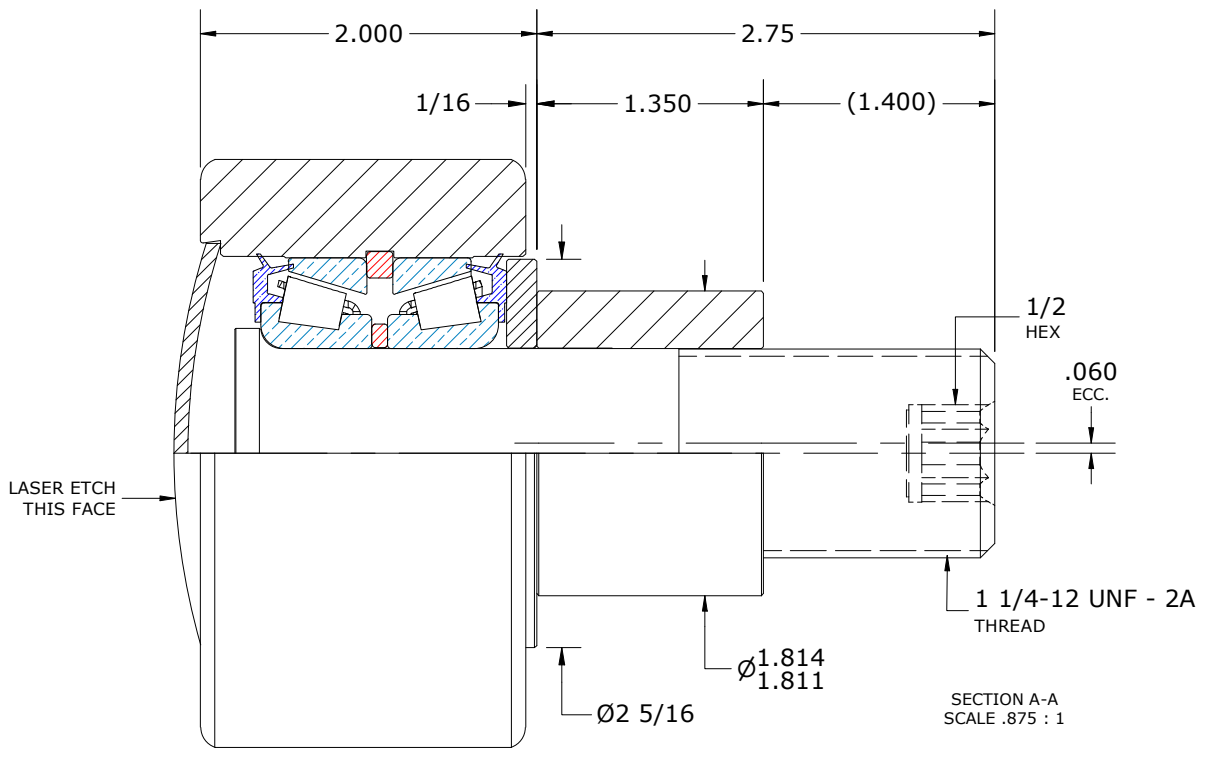
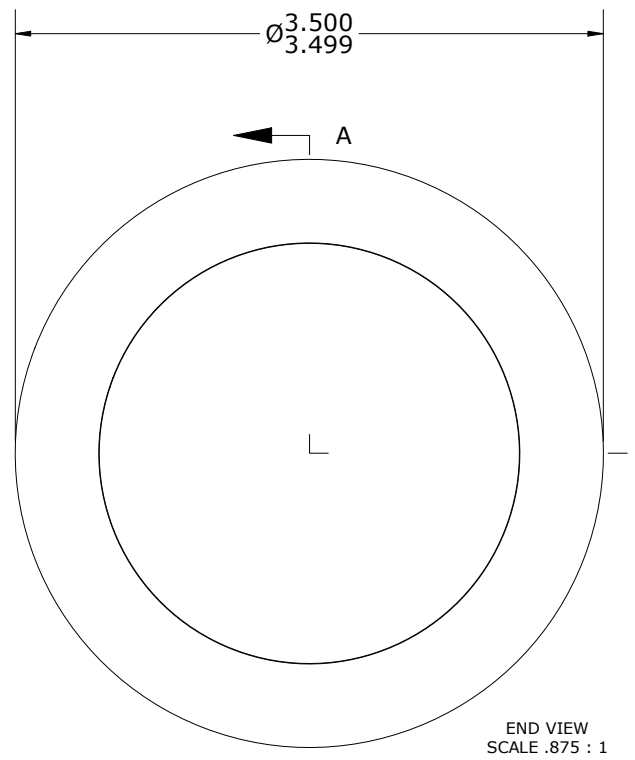
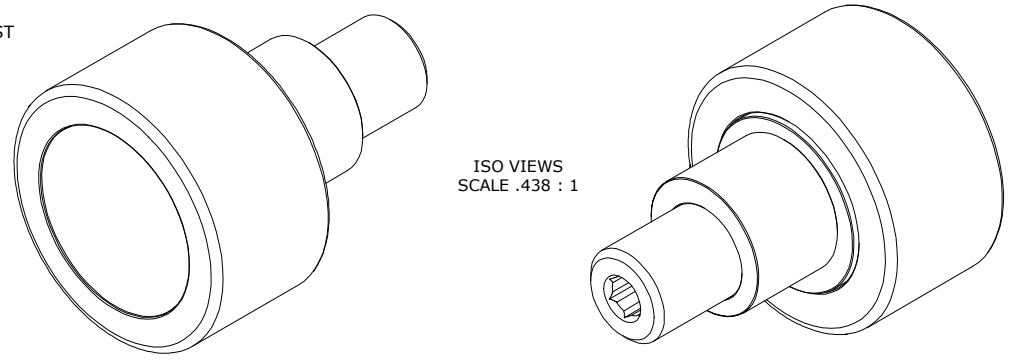

\*\*TORQUE SPECIFICATION IS BASED ON LUBRICATED THREADS, IF USING DRY THREADS DOUBLE TORQUE VALUE

MATERIAL NOTES:  
 OUTER ROLLER HOUSING - BEARING STEEL, HEAT TREATED  
 STUD, WASHER, ECCENTRIC SLEEVE & END CAP - STEEL  
 TAPERED SET - LM67000LA-902A2

CUSTOMER PART#	XX = ± .01 XXX = ± .005 XXXX = ± .0005 ANGLES = ± 2' INCH (METRIC) FRACTION = ± 1/64
<b>ENGINEERING CHANGE ORDER NOTE</b>	
CARTER STANDARD SURFACE FINISH IS MEASURED IN "Ra" UNITS UNLESS OTHERWISE SPECIFIED.	

CARTER MANUFACTURING IS NOT RESPONSIBLE FOR TYPOGRAPHICAL ERRORS				<b>CARTER MANUFACTURING CO., INC.</b> GRAND HAVEN, MICHIGAN 49417			
<b>REVISION</b>				PART NAME: ASSEMBLY		PRODUCT TYPE: Hi-Rollers™	
<b>D</b>	AUTHOR BY HG	DRAWN BY AJH	CHK'D BY MD	SALES NC	MATERIAL NOTED		
REVISION BY SGW	DATE 9/1/2023	DATE 11/14/2001	DATE 9/1/2023	DATE 9/1/2023	SHEET 1 OF 2		