

LOAD RATINGS	
RATING	Lbs
RADIAL BASIC DYNAMIC	14,200
DYNAMIC THRUST LOAD	13,000
MAXIMUM STATIC CAPACITY	26,000

- NOTES:
1. BEARING IS PACKED WITH LITHIUM BASED #2 WEIGHT GREASE
 2. STUD, ENDCAP & WASHER: HAVE BLACK OXIDE ON ALL EXPOSED SURFACES

MS NO. _____ NSN NO. _____ DRAWING NO. _____

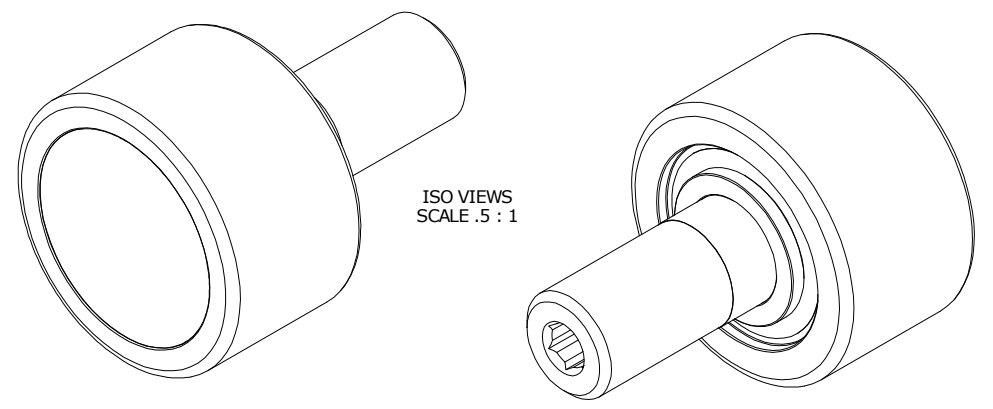

ISO VIEWS
SCALE .5 : 1

SIGNED DRAWING APPROVAL REQUIRED

PLEASE REVIEW AND VERIFY INFORMATION ON ALL SHEETS & RETURN COPY WITH SIGNED AND DATED APPROVAL, AND/OR REQUIRED CHANGES. CARTER WILL NOT PROCEED WITH ORDER UNTIL APPROVAL IS RECEIVED

SIGNED

DATE

APPROVED REJECTED

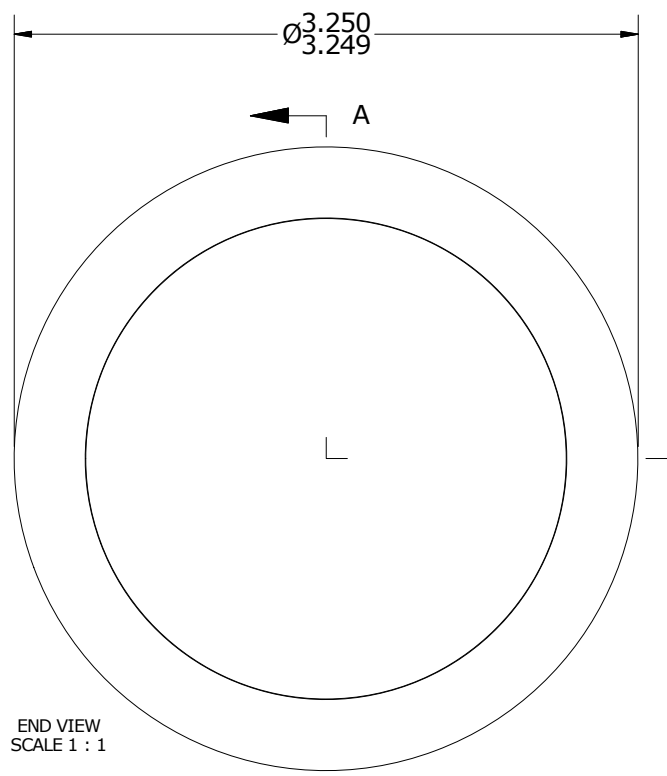

END VIEW
SCALE 1 : 1

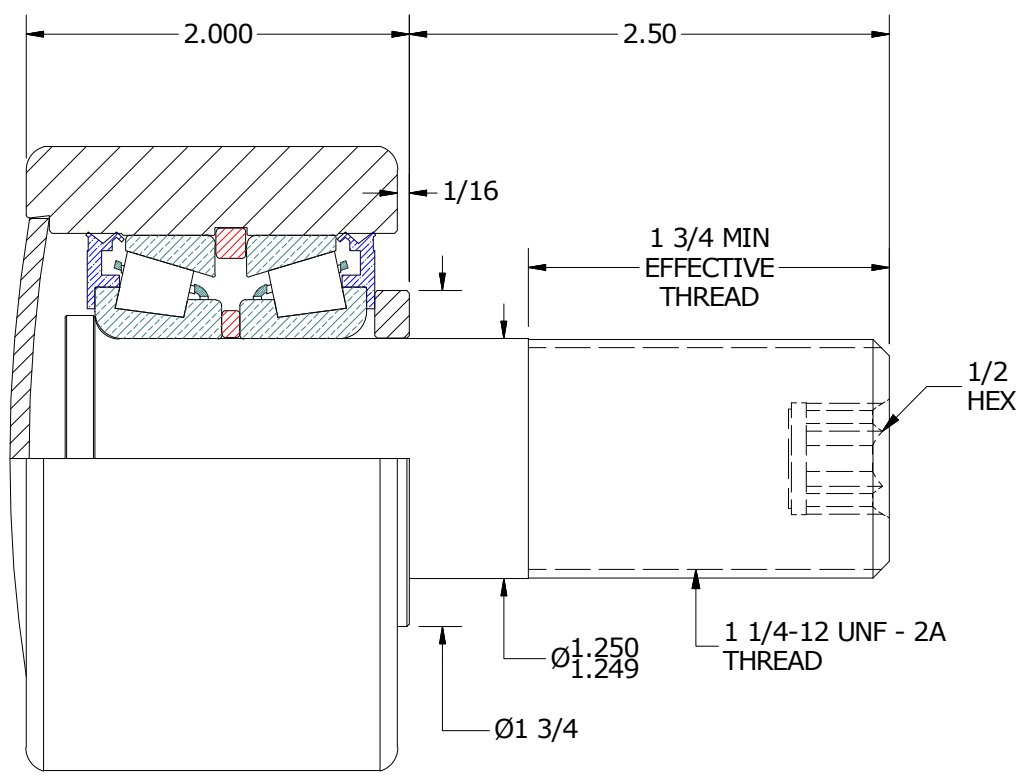

SECTION A-A
SCALE 1 : 1

MATERIAL NOTES:

OUTER ROLLER - BEARING STEEL, HEAT TREATED
 STUD - COLD ROLLED STEEL
 BEARING ASSY - LM67000LA-902A2
 WASHER - COLD ROLLED STEEL
 END CAP - COLD ROLLED STEEL

CUSTOMER PART# _____

XX = ± .01
 XXX = ± .005
 XXXX = ± .0005
 ANGLES = ± 1'
 INCH [METRIC]
 FRACTION = ± 1/32

CARTER MANUFACTURING IS NOT RESPONSIBLE FOR TYPOGRAPHICAL ERRORS

CARTER MANUFACTURING CO., INC.
 GRAND HAVEN, MICHIGAN 49417

ENGINEERING CHANGE ORDER NOTE

REVISION		PART NAME: ASSEMBLY					
B	AUTHOR BY	DRAWN BY	CHK'D BY	SALES	MATERIAL		
	HG	SGW	MD	KR	NOTED		
REVISION BY	DATE	DATE	DATE	DATE	SHEET		
SGW	3/1/2016	3/11/2010	3/1/2016	3/2/2016	1 OF 2		