

LOAD RATINGS	
RATING	Lbs
RADIAL BASIC DYNAMIC	14,270
STATIC THRUST LOAD	12,000
MAXIMUM STATIC CAPACITY	20,000

NOTES:
 1. BEARING IS PACKED WITH NLGI GRADE 2, LITHIUM BASED GREASE
 2. ALL EXPOSED SURFACES HAVE BLACK OXIDE

DRAWING NO. PHR-300-A

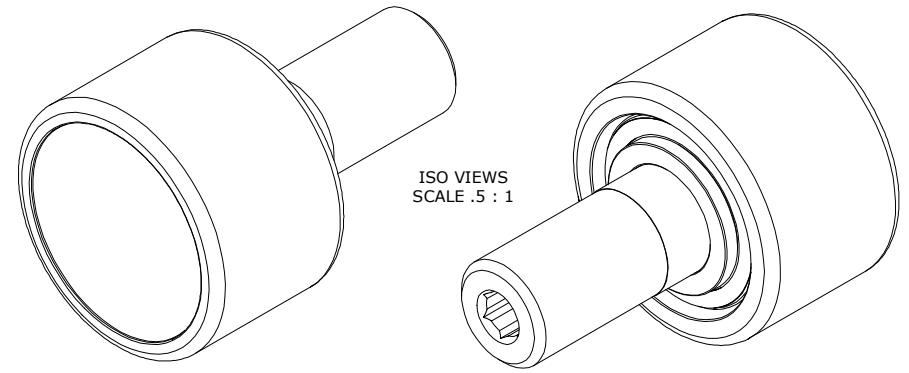

ISO VIEWS
SCALE .5 : 1

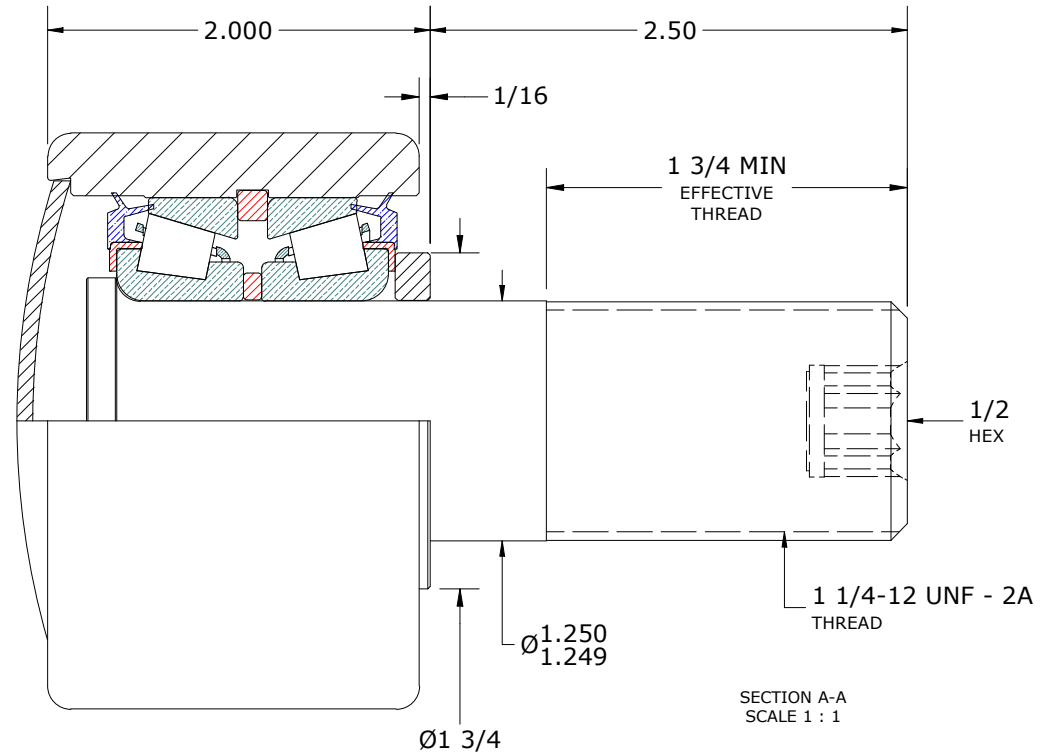
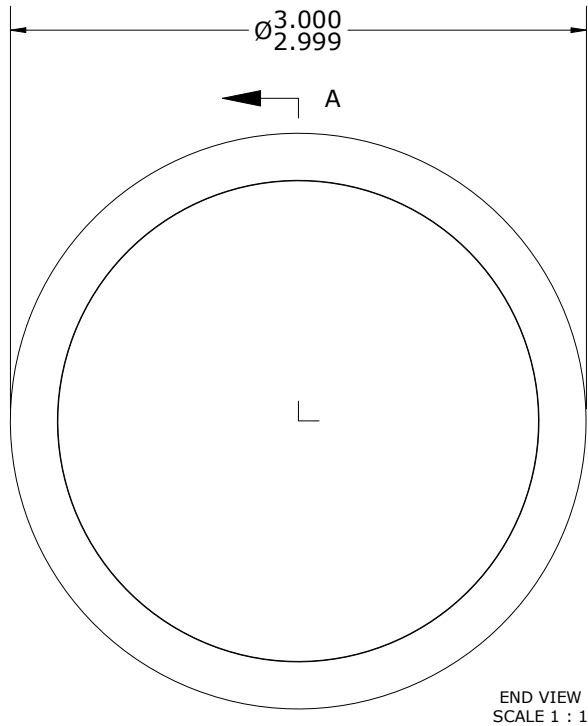

MATERIAL NOTES:

- OUTER ROLLER HOUSING - BEARING STEEL, HEAT TREATED
- STUD - STEEL
- WASHER - STEEL
- END CAP - STEEL
- BEARING ASSY - LM67000LA-902A2

CUSTOMER PART#

XX = ± .01
 XXX = ± .005
 XXXX = ± .0005
 ANGLES = ± 2'
 INCH [METRIC]
 FRACTION = ± 1/64

CARTER MANUFACTURING IS NOT RESPONSIBLE FOR TYPOGRAPHICAL ERRORS

CARTER MANUFACTURING CO., INC.

GRAND HAVEN, MICHIGAN 49417

ENGINEERING CHANGE ORDER NOTE

REVISION

PART NAME: ASSEMBLY

PRODUCT TYPE: PHR

D

AUTHOR BY

DRAWN BY

CHK'D BY

SALES

MATERIAL

HG

JGV

MD

KR

NOTED

CARTER STANDARD SURFACE FINISH IS MEASURED IN "Ra" UNITS UNLESS OTHERWISE SPECIFIED.

REVISION BY

DATE

DATE

DATE

DATE

SHEET

SGW

10/12/2018

9/3/2003

10/12/2018

10/12/2018

1 OF 2