

LOAD RATINGS	
RATING	Lbs
RADIAL BASIC DYNAMIC	2,300
DYNAMIC THRUST LOAD	1,880
MAXIMUM STATIC CAPACITY	1,300

NOTES:
 1. BALL BEARINGS COME PRE-PACKED WITH GREASE
 2. STUD AND END CAP HAVE BLACK OXIDE ON ALL EXPOSED SURFACES

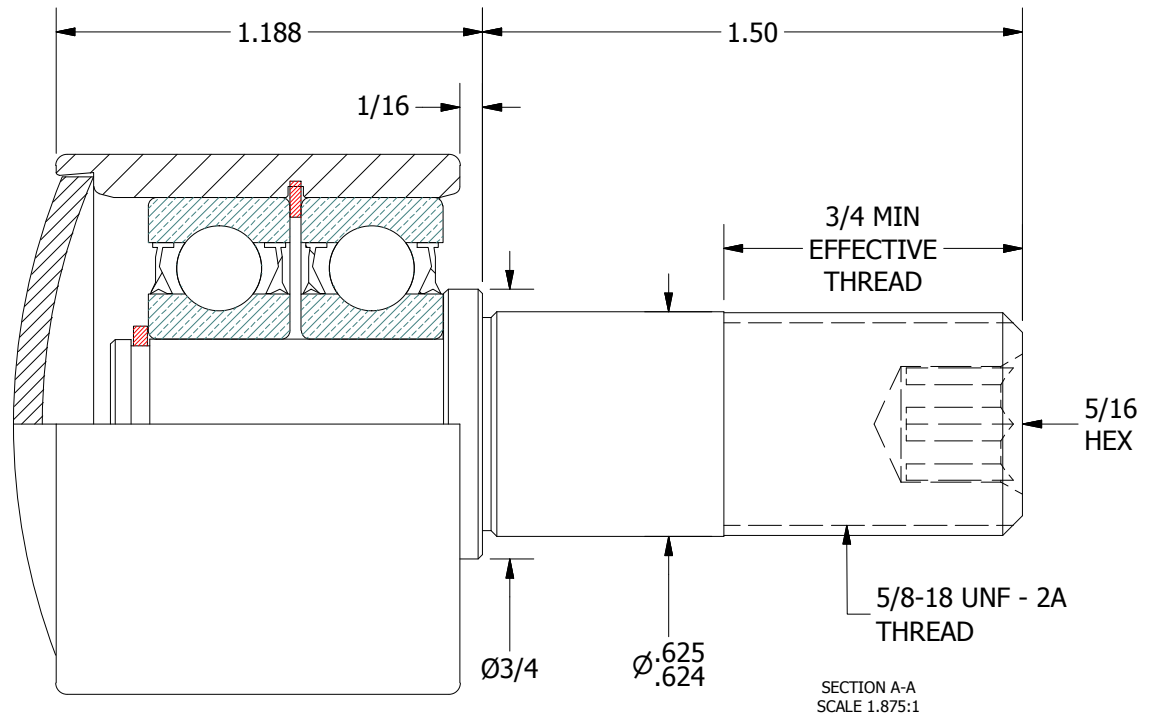
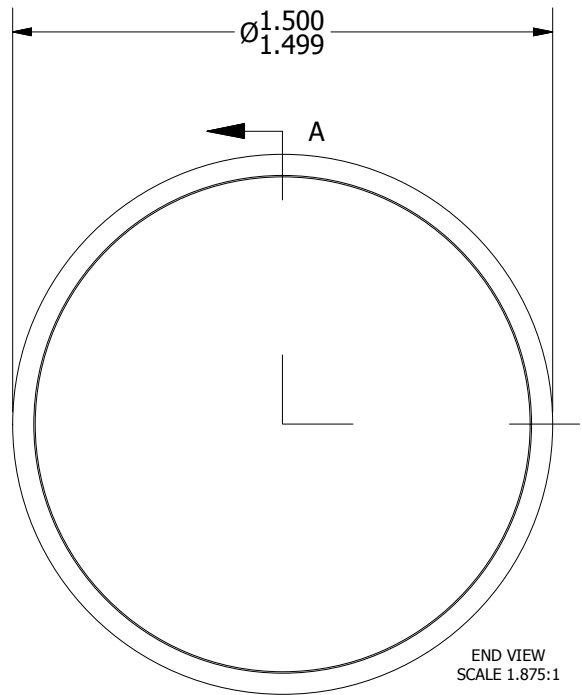
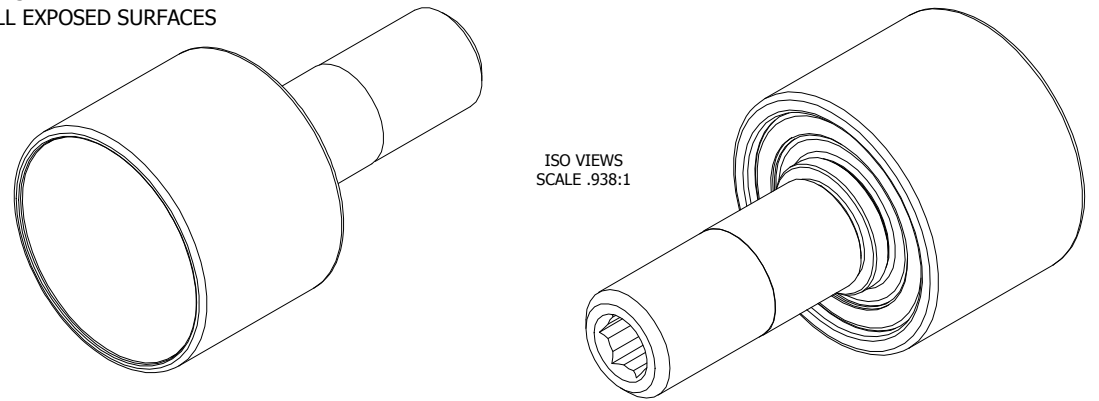

MATERIAL NOTES:

OUTER ROLLER- BEARING STEEL, HEAT TREATED
 STUD - COLD ROLLED STEEL
 BEARING ASSY. - 6201.2RS
 SNAP RINGS - SPRING STEEL
 END CAP - COLD ROLLED STEEL

CUSTOMER PART#	.XX = ± .01 .XXX = ± .005 .XXXX = ± .0005 ANGLES = ± 1' INCH [METRIC] FRACTION = ± 1/32
CHANGE NOTE:	

CARTER MANUFACTURING IS NOT RESPONSIBLE FOR TYPOGRAPHICAL ERRORS

CARTER MANUFACTURING CO., INC.
 GRAND HAVEN, MICHIGAN 49417

REVISION		PART NAME: ASSEMBLY			SHEET 1 OF 2	
C	AUTHOR. BY	DRAWN BY	CHK'D BY	SALES	MATERIAL	
	DB	RAM	MD	KR	NOTED	
	REV. BY	DATE	DATE	DATE	DATE	DRAWING NO.
SGW	5/28/2013	12/27/1996	5/28/2013	5/27/2013	PHR-150-A	