

ISO/ABMA BASIC LOAD RATINGS		
Rating	Newtons	Lbs
DYNAMIC	20,300	4,564
STATIC	34,130	7,673

TRACK ROLLER LOAD RATINGS		
RATING	Newtons	Lbs
DYNAMIC	16,970	3,815
STATIC	28,500	6,407

MAXIMUM CLAMPING TORQUE		
Thread Type	Nm	Inch Lbs
DRY	57	504
LUBRICATED	28.5	252

RECOMMENDED MOUNTING HOLE Ø		
Limit	mm	Inch
MIN	16.000	.6299
MAX	16.018	.6306

MS NO. _____ NSN NO. _____ DRAWING NO. **MCNB-35-SBX**

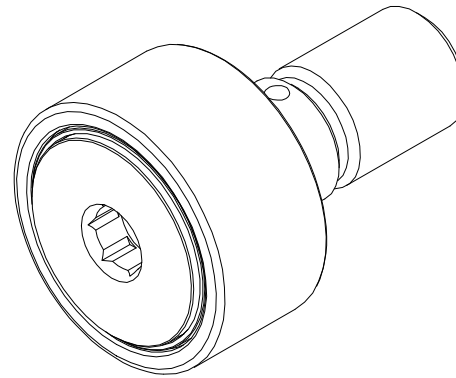

ISO VIEWS
SCALE 1.125:1

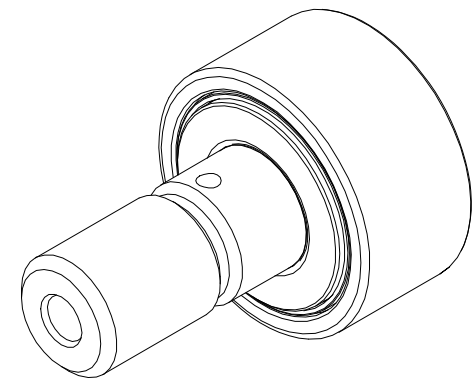

NOTES:

- BEARING IS PACKED WITH NLGI GRADE 2, LITHIUM BASED GREASE (UNLESS OTHERWISE SPECIFIED)
- ALL EXPOSED SURFACES HAVE BLACK OXIDE
- CUSTOM LASER ETCHING IS AVAILABLE UPON REQUEST
- LIMITING SPEEDS:
 - GREASE = 4,200 RPM
 - OIL = 5,500 RPM

SIGNED DRAWING APPROVAL REQUIRED			
PLEASE REVIEW AND VERIFY INFORMATION ON ALL SHEETS & RETURN COPY WITH SIGNED AND DATED APPROVAL, AND/OR REQUIRED CHANGES. CARTER WILL NOT PROCEED WITH ORDER UNTIL APPROVAL IS RECEIVED			
SIGNED _____	DATE _____	APPROVED <input type="checkbox"/>	REJECTED <input type="checkbox"/>

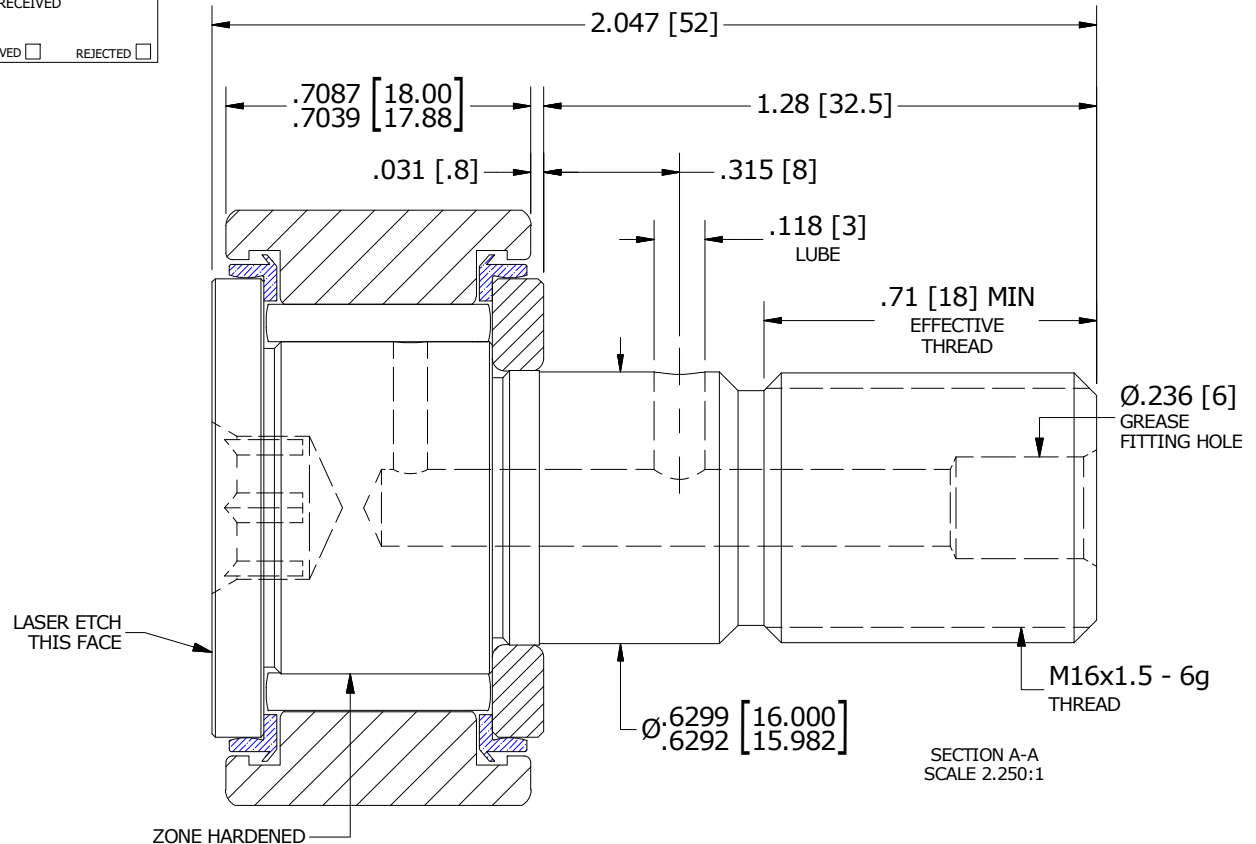
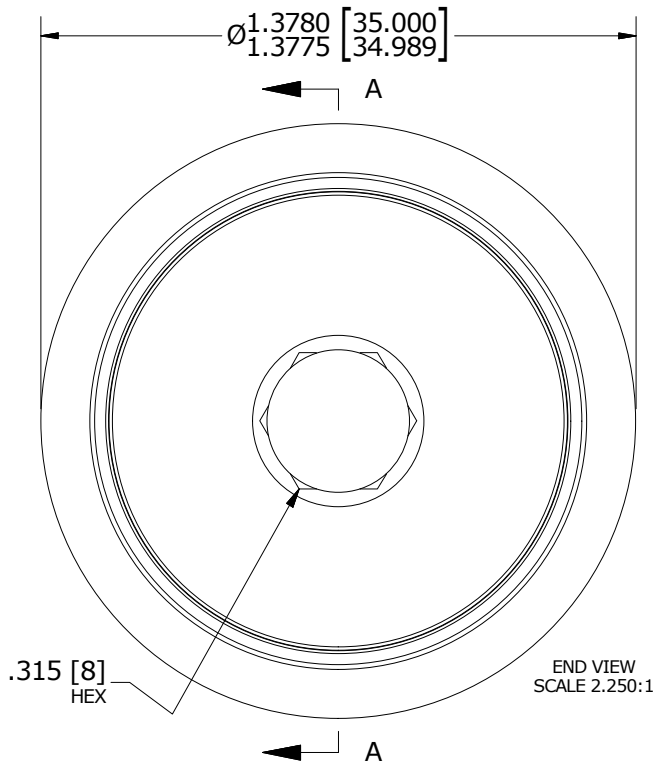

MATERIAL NOTES:

OUTER RING - BEARING STEEL, HEAT TREATED
 STUD - BEARING STEEL, ZONE HARDENED
 NEEDLE ROLLER(S) - BEARING STEEL, HEAT TREATED
 WASHER - BEARING STEEL, HEAT TREATED
 SEAL(S) - SYNTHETIC

CUSTOMER PART#	XX = ± .01 XXX = ± .005 XXXX = ± .0005 ANGLES = ± 1' INCH [METRIC] FRACTION = ± 1/32
ENGINEERING CHANGE ORDER NOTE	

CARTER MANUFACTURING IS NOT RESPONSIBLE FOR TYPOGRAPHICAL ERRORS	
REVISION	
A	AUTHOR BY HG
REVISION BY SGW	DATE 2/10/2015

CARTER MANUFACTURING CO., INC. GRAND HAVEN, MICHIGAN 49417			
PART NAME: ASSEMBLY			PRODUCT TYPE: MCNB
DRAWN BY SGW	CHK'D BY MD	SALES KR	MATERIAL NOTED
DATE 10/29/2014	DATE 1/27/2015	DATE 8/13/2015	SHEET 1 OF 2