

**NOTES:**

- 1. BEARING IS PACKED WITH GREASE
- 2. ALL EXPOSED SURFACES ARE BLACK OXIDED

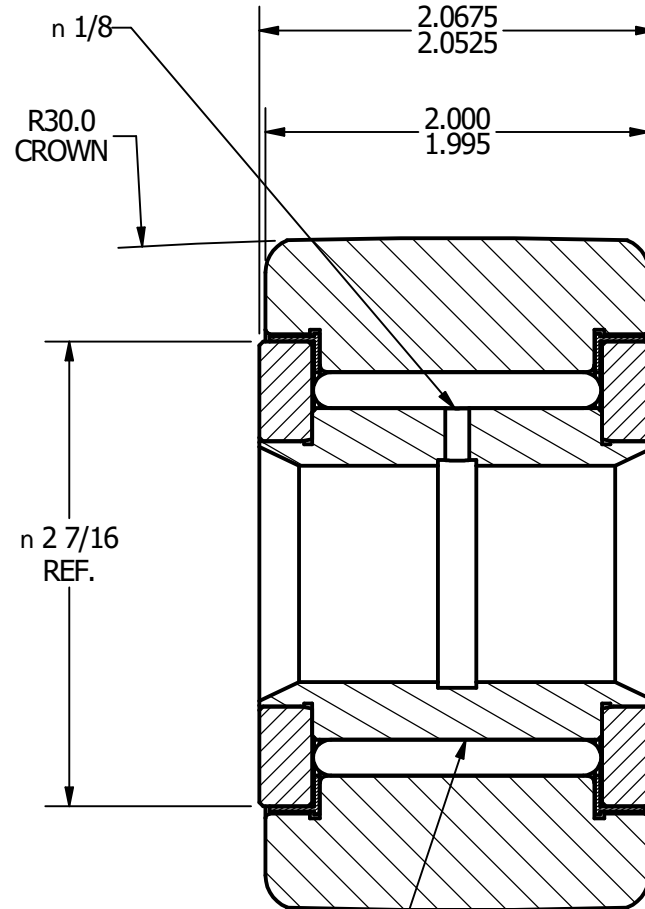
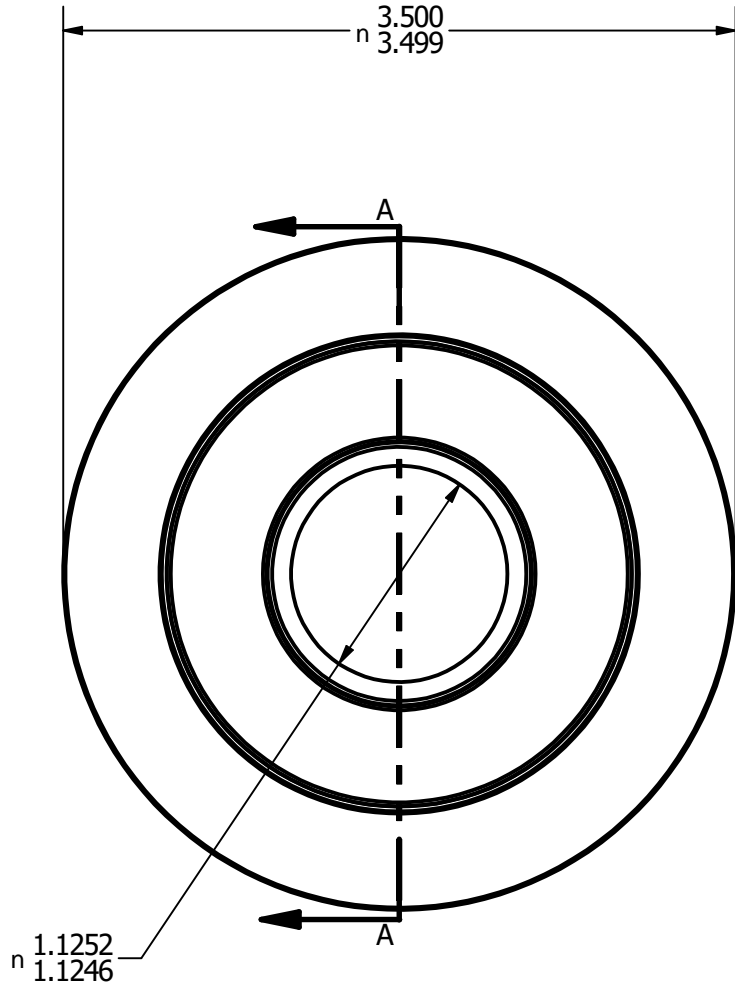
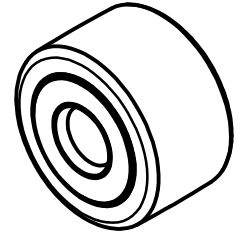

**RADIAL BASIC DYNAMIC RATING (POUNDS) 22,800**

**MAXIMUM STATIC CAPACITY (POUNDS) 63,250**

**MATERIAL NOTES:**

- OUTER - BEARING STEEL, HEAT TREATED**
- STUD - BEARING STEEL, ZONE HARDENED**
- NEEDLE - BEARING STEEL, HEAT TREATED**
- WASHER - COLD ROLLED STEEL, HEAT TREATED**
- SEAL - SYNTHETIC**

CUSTOMER PART#

.XX = .01  
 .XXX = .005  
 .XXXX = .0005  
 ANGLES = 1°  
 INCH [METRIC]

CARTER MANUFACTURING IS NOT RESPONSIBLE FOR TYPOGRAPHICAL ERRORS

**CARTER MANUFACTURING CO., INC.**

GRAND HAVEN, MICHIGAN 49417

REVISION

PART NAME: **ASSEMBLY**

SHEET 1 OF 2

CHANGE NOTE:

**A**

**AUTHOR. BY**

**DRAWN BY**

**CHK'D BY**

**SALES**

**MATERIAL**

JGV

JAF

JGV

KPR

NOTED

**REV. BY**

**DATE**

**DATE**

**DATE**

**DATE**

**DRAWING NO.**

JAF

8/4/2006

8/4/2006

8/4/2006

8/2/2006

**CYNB-112-S**