

LOAD RATINGS	
RATING	Lbs
RADIAL BASIC DYNAMIC	5,190
DYNAMIC THRUST LOAD	2,660
MAXIMUM STATIC CAPACITY	3,270

- NOTES:
1. BALL BEARINGS COME PRE-PACKED WITH GREASE
  2. STUD, OUTER AND ENDCAP: ALL EXPOSED SURFACES HAVE BLACK OXIDE
  3. CUSTOM LASER ETCHING UPON REQUEST
  4. THE BALL BEARING COEFFICIENT OF FRICTION = .0015  $\mu$

MS NO. \_\_\_\_\_ NSN NO. \_\_\_\_\_ DRAWING NO. CPHR-250-A

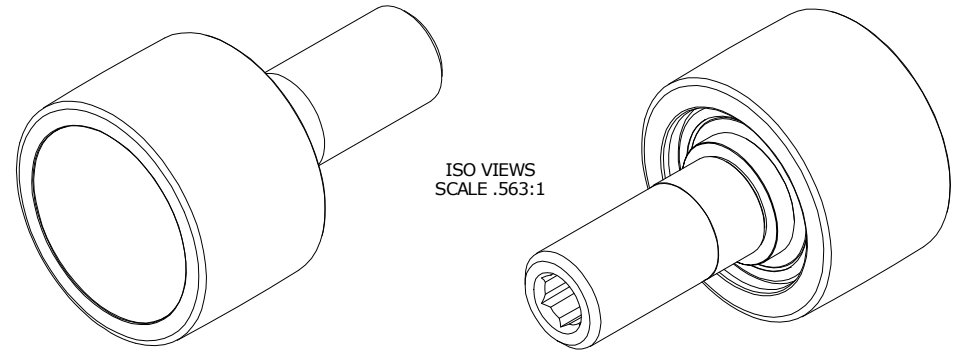

**SIGNED DRAWING APPROVAL REQUIRED**

PLEASE REVIEW AND VERIFY INFORMATION ON ALL SHEETS & RETURN COPY WITH SIGNED AND DATED APPROVAL, AND/OR REQUIRED CHANGES. CARTER WILL NOT PROCEED WITH ORDER UNTIL APPROVAL IS RECEIVED

\_\_\_\_\_  
SIGNED

\_\_\_\_\_  
DATE

APPROVED  REJECTED

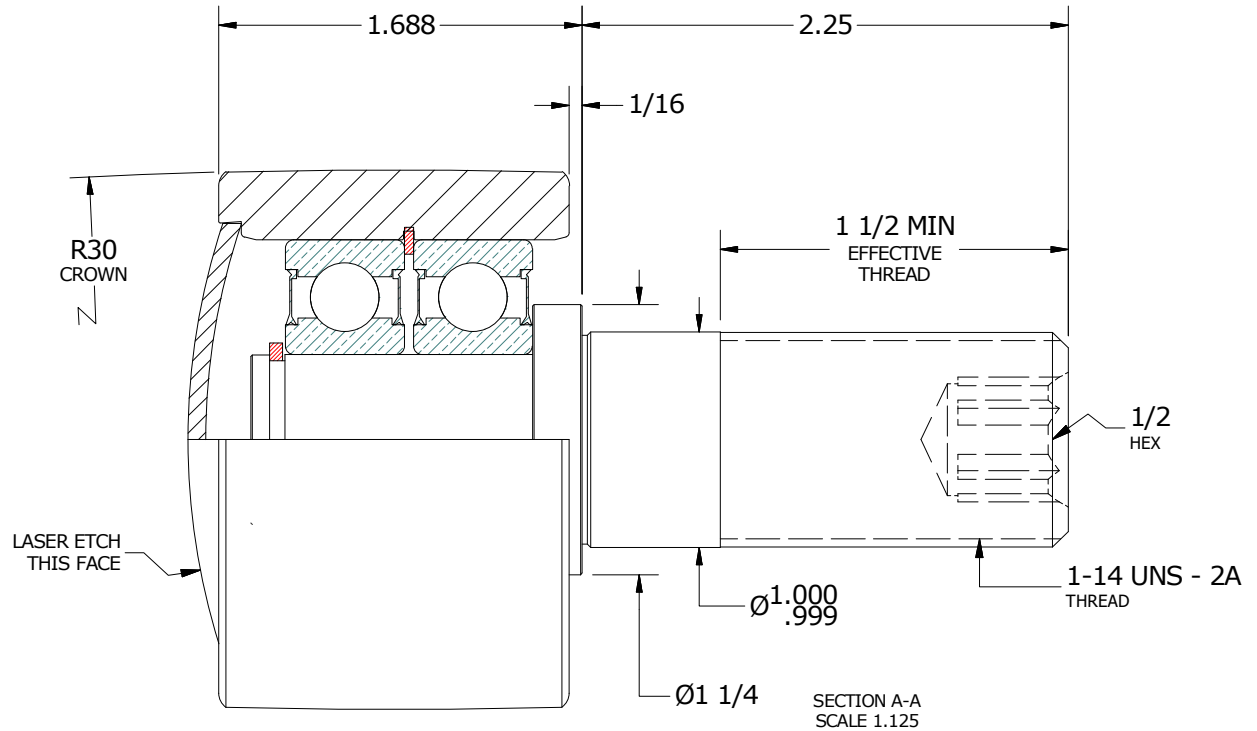
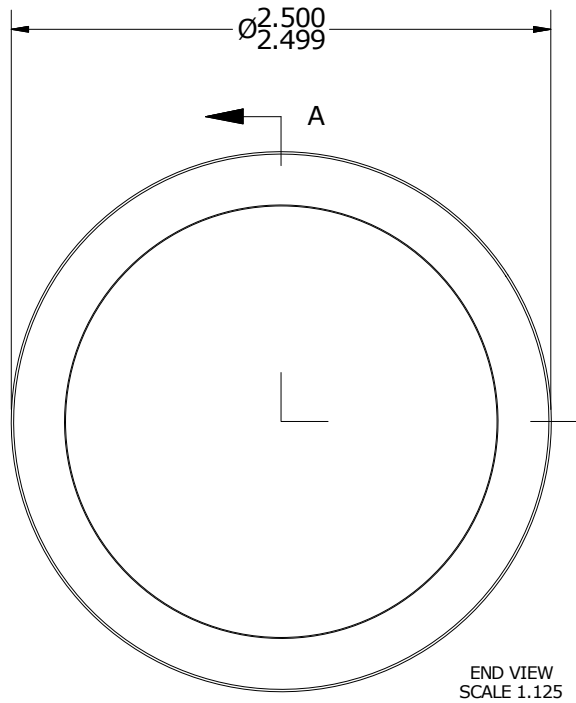

MATERIAL NOTES:

- OUTER ROLLER HOUSING - BEARING STEEL, HEAT TREATED
- STUD - STEEL
- END CAP - STEEL
- BEARING ASSEMBLY - 6204 2RS
- RETAINING RINGS - SPRING STEEL

CUSTOMER PART#

XX =  $\pm .01$   
 XXX =  $\pm .005$   
 XXXX =  $\pm .0005$   
 ANGLES =  $\pm 1'$   
 INCH [METRIC]  
 FRACTION =  $\pm 1/32$

CARTER MANUFACTURING IS NOT RESPONSIBLE FOR TYPOGRAPHICAL ERRORS

**CARTER MANUFACTURING CO., INC.**  
 GRAND HAVEN, MICHIGAN 49417

ENGINEERING CHANGE ORDER NOTE

REVISION

PART NAME: ASSEMBLY

PRODUCT TYPE: PHR

**B**

AUTHOR BY  
HG

DRAWN BY  
MD

CHK'D BY  
KR

SALES  
KR

MATERIAL  
NOTED

REVISION BY  
SGW

DATE  
12/3/2018

DATE  
5/21/2009

DATE  
12/3/2018

DATE  
5/19/2009

SHEET  
1 OF 2