

LOAD RATINGS		
RATING	lbf	Newtons
RADIAL BASIC DYNAMIC	22,800	101,419
MAXIMUM STATIC CAPACITY	31,625	140,675

- NOTES:
- BEARING IS PACKED WITH NLGI GRADE 2, LITHIUM BASED GREASE (UNLESS OTHERWISE SPECIFIED)
  - ALL EXPOSED STEEL SURFACES HAVE BLACK OXIDE
  - CUSTOM LASER ETCHING UPON REQUEST
  - LIMITING SPEED:
    - A. GREASE = 820 RPM

RECOMMENDED MOUNTING HOLE Ø		
Limit	Inch	mm
MIN	1.814	46.0756
MAX	1.816	46.1264

MAXIMUM CLAMPING TORQUE**		
Thread Type	Inch lbf	Nm
LUBRICATED	2,100	237

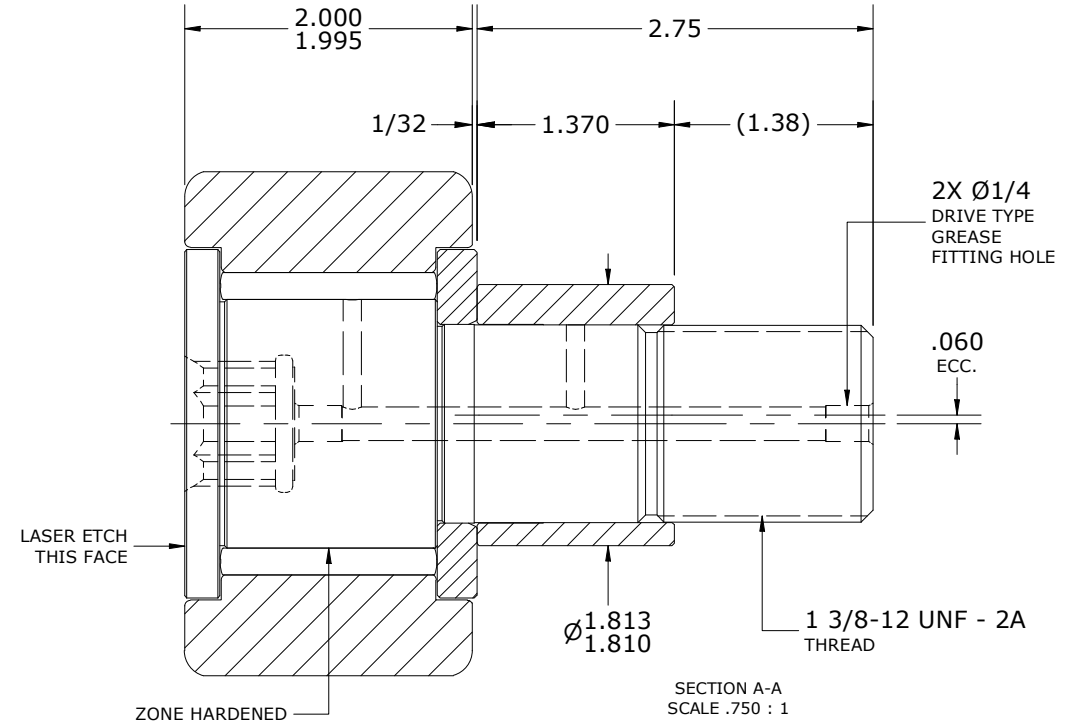
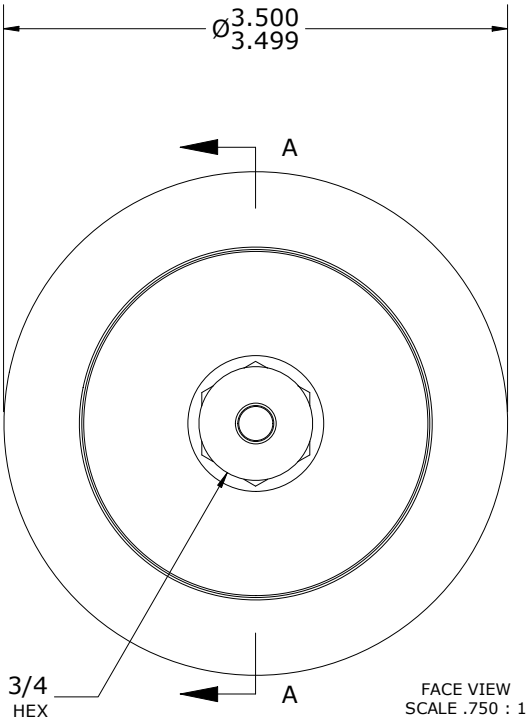
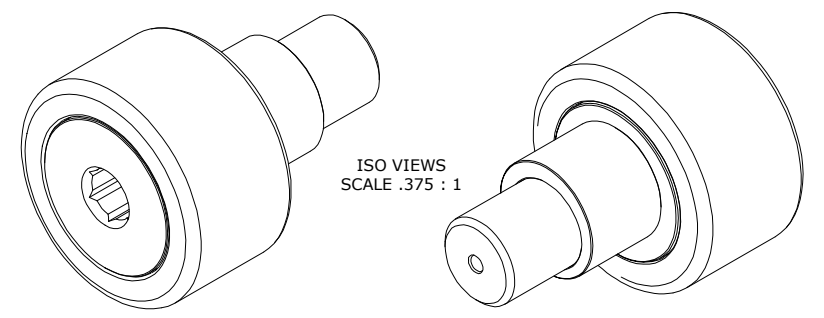

\*\* (TORQUE SPECIFICATION IS BASED ON LUBRICATED THREADS, IF USING DRY THREADS DOUBLE TORQUE VALUE)

**MATERIAL NOTES:**

OUTER RING - BEARING STEEL, HEAT TREATED

STUD - BEARING STEEL, ZONE HARDENED

NEEDLE ROLLER(S) - BEARING STEEL, HEAT TREATED

WASHER - BEARING STEEL, HEAT TREATED

ECCENTRIC SLEEVE - COLD ROLLED STEEL

<i>CUSTOMER PART#</i>	XX = ± .01 XXX = ± .005 XXXX = ± .0005 ANGLES = ± 2' INCH [METRIC] FRACTION = ± 1/64
<b>ENGINEERING CHANGE ORDER NOTE</b>	
CARTER STANDARD SURFACE FINISH IS MEASURED IN "Ra" UNITS UNLESS OTHERWISE SPECIFIED.	

CARTER MANUFACTURING IS NOT RESPONSIBLE FOR TYPOGRAPHICAL ERRORS		<b>CARTER MANUFACTURING CO., INC.</b> GRAND HAVEN, MICHIGAN 49417			
<b>REVISION</b>		PART NAME: Assembly		PRODUCT TYPE: Standard CF/YR	
<b>B</b>	AUTHOR BY HG	DRAWN BY JAF	CHK'D BY MD	SALES KPR	MATERIAL NOTED
REVISION BY DJB	DATE 8/22/2023	DATE 7/7/2006	DATE 8/22/2023	DATE 7/6/2006	SHEET 1 OF 2