

LOAD RATINGS	
RATING	Lbs
RADIAL BASIC DYNAMIC [C]	14,100
MAXIMUM STATIC CAPACITY [Co]	24,400

NOTES:
 1. BEARING IS LIGHTLY COATED WITH RUST/CORROSION INHIBITING OIL
 2. OUTER RACE HAS BLACK OXIDE ON ALL EXPOSED SURFACES

MS NO. MS-51961-28		NSN NO.	
Recommended Housing Fits			
Fits	Housing Max Ø	Housing Min Ø	
Clearance	2.3132	2.3125	
Tight Transition	2.3121	2.3114	

DRAWING NO. **CMR-28**
 ISO VIEW
 SCALE .688 : 1

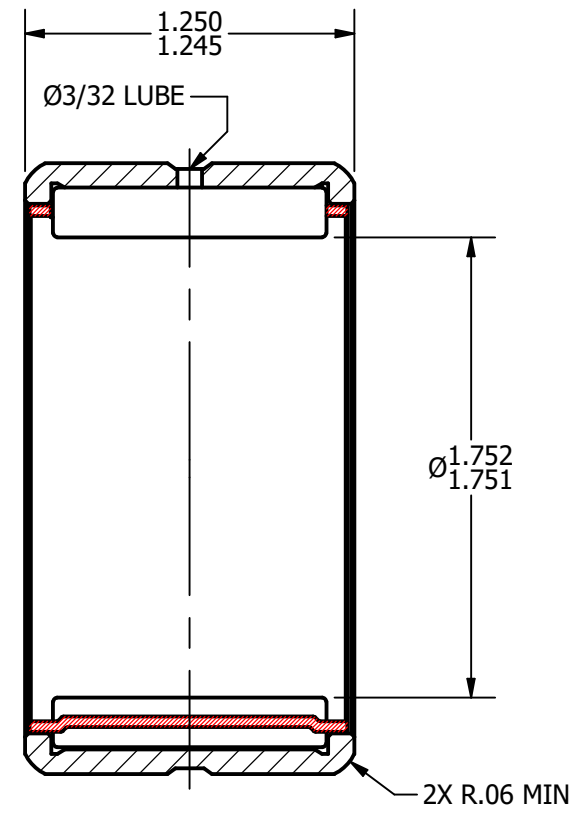
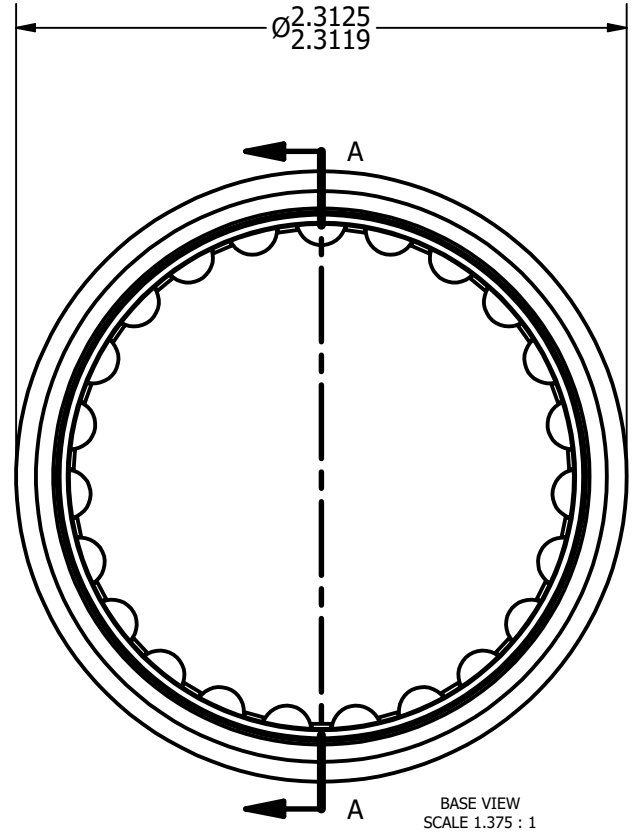
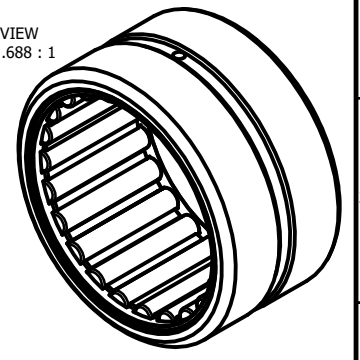

MATERIAL NOTES:
 OUTER - BEARING STEEL, HEAT TREATED
 CAGE - COLD ROLLED STEEL
 ROLLER - BEARING STEEL, HEAT TREATED

CUSTOMER PART#
 McGill#MR-28
 Torrington#HJ-283720
 RBC #SJ7315

CHANGE NOTE:

.XX = ± .01
 .XXX = ± .005
 .XXXX = ± .0005
 ANGLES = ± 1'
 INCH [METRIC]
 FRACTION = ± 1/32

CARTER MANUFACTURING IS NOT RESPONSIBLE FOR TYPOGRAPHICAL ERRORS

REVISION

A	AUTHOR. BY	DRAWN BY	CHK'D BY	SALES	MATERIAL
	DB	SGW	MD	KR	NOTED
	REV. BY	DATE	DATE	DATE	DRAWING NO.
	SGW	5/3/2011	4/29/2011	5/3/2011	4/29/2011

CARTER MANUFACTURING CO., INC.
 GRAND HAVEN, MICHIGAN 49417

PART NAME: **ASSEMBLY** SHEET 1 OF 2