

LOAD RATINGS	
RATING	Lbs
RADIAL BASIC DYNAMIC [C]	13,300
MAXIMUM STATIC CAPACITY [Co]	22,100

- NOTES:
 1. BEARING IS LIGHTLY COATED WITH RUST/CORROSION INHIBITING OIL
 2. OUTER RACE HAS BLACK OXIDE ON ALL EXPOSED SURFACES

MS NO. MS-51961-25		DRAWING NO. CMR-26	
Recommended Housing Fits			
Fits	Housing Max Ø	Housing Min. Ø	
Clearance	2.1882	2.1875	
Tight Transition	2.1871	2.1864	

ISO VIEW
SCALE .75 : 1

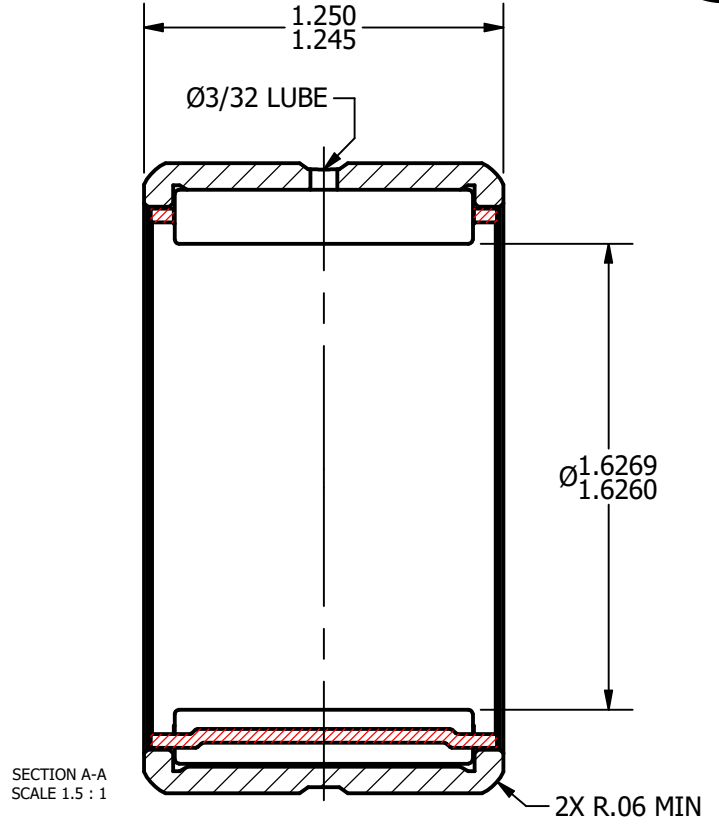
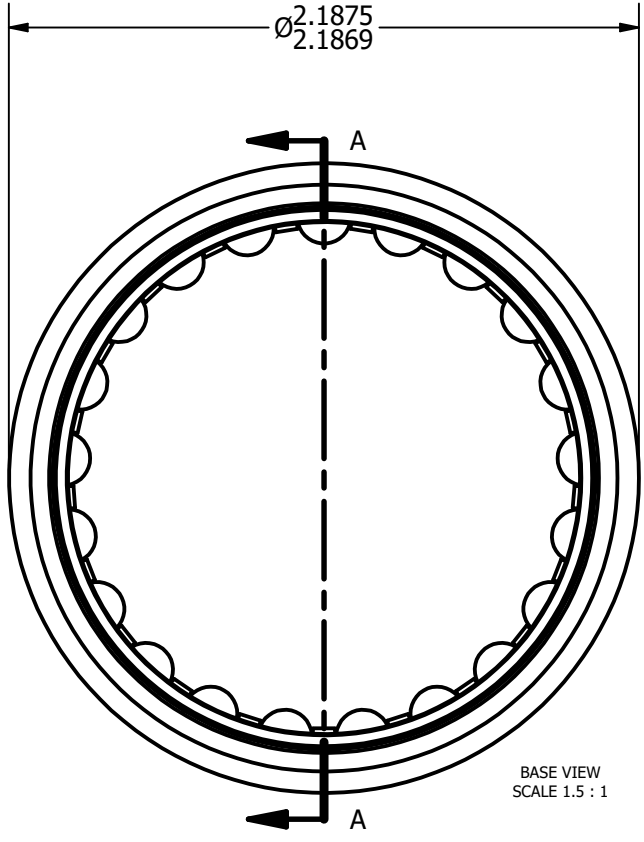
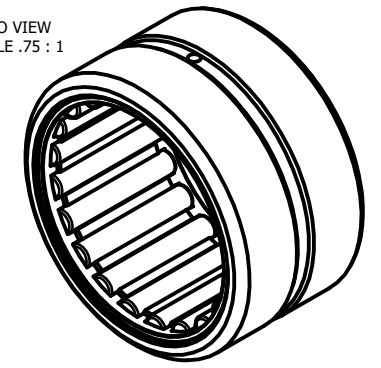

MATERIAL NOTES:
 OUTER - BEARING STEEL, HEAT TREATED
 CAGE - COLD ROLLED STEEL
 ROLLER - BEARING STEEL, HEAT TREATED

CUSTOMER PART#
 McGill#MR-26
 RBC #SJ7295
 Torrington#HJ-263520

CHANGE NOTE:

.XX = ± .01
 .XXX = ± .005
 .XXXX = ± .0005
 ANGLES = ± 1'
 INCH [METRIC]
 FRACTION = ± 1/32

CARTER MANUFACTURING IS NOT RESPONSIBLE FOR TYPOGRAPHICAL ERRORS

REVISION

A	AUTHOR. BY	DRAWN BY	CHK'D BY	SALES	MATERIAL
	DB	SGW	MD	KR	NOTED
REV. BY	DATE	DATE	DATE	DATE	DRAWING NO.
SGW	5/3/2011	4/27/2011	5/3/2011	4/27/2011	CMR-26

CARTER MANUFACTURING CO., INC.
 GRAND HAVEN, MICHIGAN 49417

PART NAME: **ASSEMBLY** SHEET 1 OF 2