

LOAD RATINGS		
RATING	lbf	Newtons
RADIAL BASIC DYNAMIC	8,200	36,475
MAXIMUM STATIC CAPACITY	10,500	46,706

RECOMMENDED MOUNTING HOLE Ø		
Limit	Inch	mm
MIN	.7498	19.045
MAX	.7505	19.063

MAXIMUM CLAMPING TORQUE**		
Thread Type	Inch Lbs	Nm
LUBRICATED	625	70.5

MS NO. _____ NSN NO. _____ DRAWING NO. _____ CCDR-175-S

- NOTES:
1. BEARING IS PACKED WITH NLGI GRADE 2, LITHIUM BASED GREASE (UNLESS OTHERWISE SPECIFIED)
 2. ALL EXPOSED SURFACES AS MOUNTED HAVE BLACK OXIDE
 3. LIMITING SPEED:
 - A. GREASE = 4,700 RPM
 4. CUSTOM LASER ETCHING UPON REQUEST

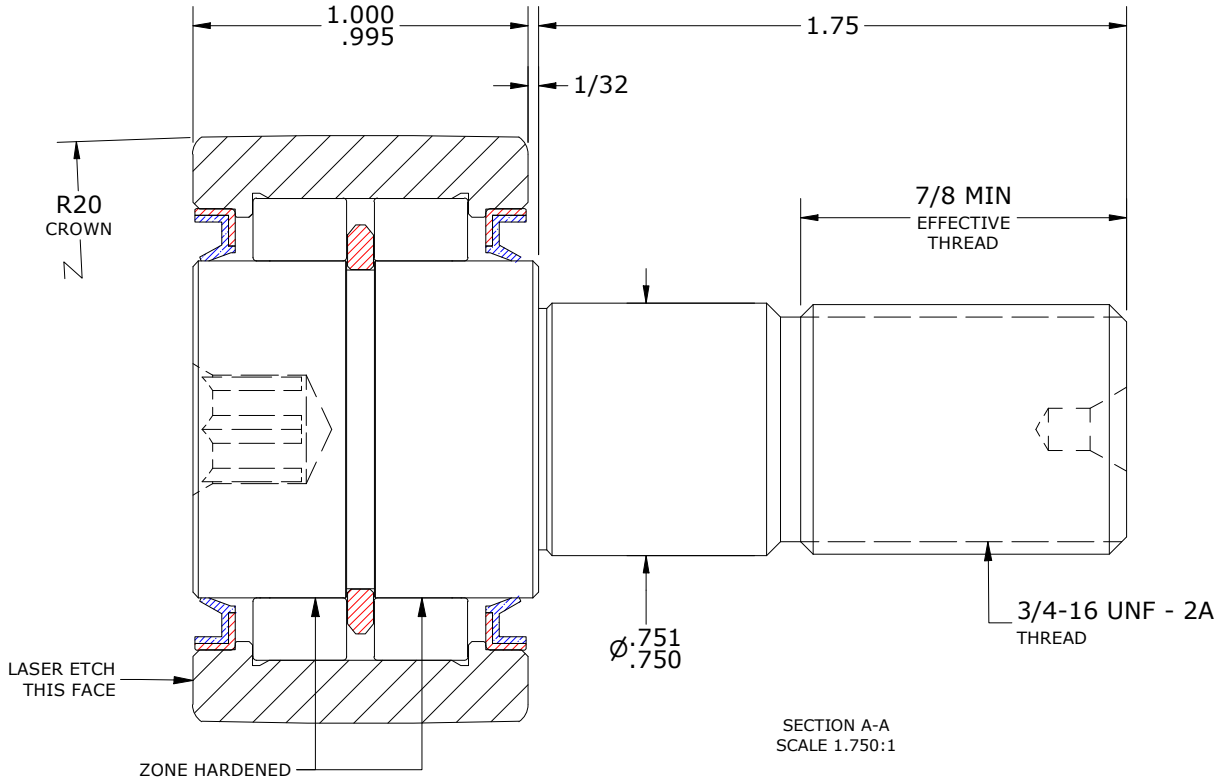
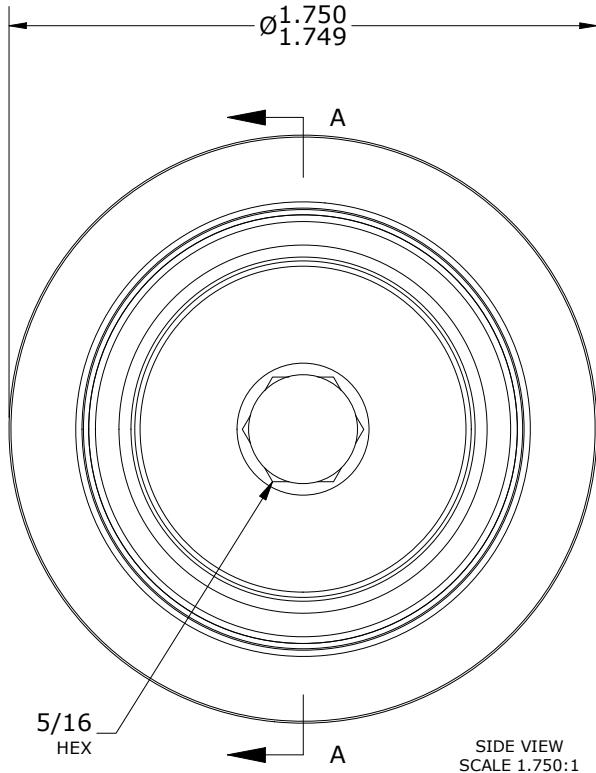

**TORQUE SPECIFICATION IS BASED ON LUBRICATED THREADS, IF USING DRY THREADS DOUBLE TORQUE VALUE

MATERIAL NOTES:

- OUTER RING - BEARING STEEL, HEAT TREATED
- STUD - BEARING STEEL, ZONE HARDENED
- NEEDLE ROLLER(S) - BEARING STEEL, HEAT TREATED
- RETAINING RING - BEARING STEEL, HEAT TREATED
- SEAL(S) - VB TYPE OIL SEAL

CUSTOMER PART#	XX = ± .01 XXX = ± .005 XXXX = ± .0005 ANGLES = ± 1' INCH [METRIC] FRACTION = ± 1/32
ENGINEERING CHANGE ORDER NOTE	

CARTER MANUFACTURING IS NOT RESPONSIBLE FOR TYPOGRAPHICAL ERRORS

CARTER MANUFACTURING CO., INC.
GRAND HAVEN, MICHIGAN 49417

REVISION		PART NAME: ASSEMBLY			PRODUCT TYPE: CDR	
A	AUTHOR BY HG	DRAWN BY SGW	CHK'D BY MD	SALES NC	MATERIAL NOTED	
REVISION BY SGW	DATE 4/30/2021	DATE 4/26/2021	DATE 4/29/2021	DATE 4/30/2021	SHEET 1 OF 2	