

CARTER[®]

Metric Bearings



MADE IN THE USA

CARTER®

Bearings Are Our Business

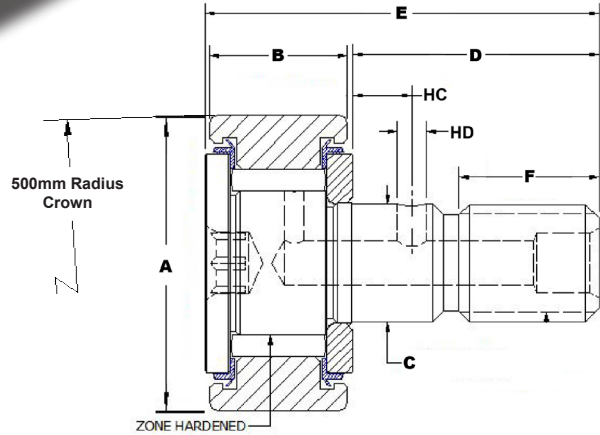

Metric Needle Bearing Dimensions

Carter No.	ROLLER DIA. RD	ROLLER WIDTH	STUD DIA.	STUD LENGTH	OVERALL LENGTH	ENDPLATE EXTENSION	THREAD	THREAD LENGTH	OIL HOLE	
	A - mm	B - mm	C - mm	D - mm	E - mm	mm	mm	F - mm	(HC)	(HD)
MCNB-16-SB	16	11	6	16	28	0.6	M6x1	9	-	-
MCNB-19-SB	19	11	8	20	32	0.6	M8x1.25	11	-	-
MCNB-22-SB	22	12	10	23	36	0.6	M10x1	12	-	-
MCNB-26-SB	26	12	10	23	36	0.6	M10x1	12	-	-
MCNB-30-SB	30	14	12	25	40	0.6	M12x1.5	14	6	3
MCNB-32-SB	32	14	12	25	40	0.6	M12x1.5	14	6	3
MCNB-35-SB	35	18	16	32.5	52	0.8	M16x1.5	18	8	3
MCNB-40-SB	40	20	18	36.5	58	0.8	M18x1.5	19	8	3
MCNB-47-SB	47	24	20	40.5	66	0.8	M20x1.5	21	9	4
MCNB-52-SB	52	24	20	40.5	66	0.6	M20x1.5	21	9	4
MCNB-62-SB	62	29	24	49.5	80	0.8	M24x1.5	25	11	4

Eccentric Bearing Dimensions

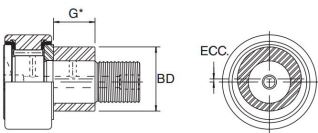

For positive clamping mounting housing thickness should be 0.3mm greater than the "G" dimension shown.

For the remaining standard dimensions, see the chart above. Cylindrical versions of each are available, and are denoted by an X in the suffix (i.e. MCNB-16-SBX).

Carter No.	G	BD		ECCENTRICITY	RECOMMENDED HOUSING BORE DIA.
	mm	MIN. (mm)	MAX (mm)		+0.025 -0.00 mm
MCNBE-16-SB	7	8.964	9	0.5	9.050
MCNBE-19-SB	9	10.957	11	0.5	11.050
MCNBE-22-SB	10	12.957	13	0.5	13.050
MCNBE-26-SB	10	12.957	13	0.5	13.050
MCNBE-30-SB	11	14.957	15	0.5	15.050
MCNBE-32-SB	11	14.957	15	0.5	15.050
MCNBE-35-SB	14	19.948	20	1.0	20.050
MCNBE-40-SB	16	21.948	22	1.0	22.050
MCNBE-47-SB	18	23.948	24	1.0	24.050
MCNBE-52-SB	18	23.948	24	1.0	24.050
MCNBE-62-SB	22	27.948	28	1.0	28.050
MCNBE-72-SB	22	27.948	28	1.0	28.050